

 SILVERSEA®

The background of the entire page is a photograph of a savanna landscape at sunset. Several tall baobab trees with thick trunks and sparse, flat-topped canopies stand in a field. In the foreground, there is a body of water with lily pads, which reflects the trees and the warm orange and yellow light of the setting sun. The sky is a clear, pale blue.

SOUTH SIDE STORY

All The World's A Stage

WORLD CRUISE 2023

SYDNEY TO FORT LAUDERDALE | 09 JAN - 28 MAY 2023

 SILVERSEA®

**SOUTH
SIDE
STORY**

All The World's A Stage



Fort Lauderdale

San Juan

Gustavia

St John's

Mayreau

Ile Royale

Boca Da Valeria

Manaus

Parintins

Santarém

Cruising the Amazon River

Mindelo

Praia

Dakar

Banjul

Takoradi

Accra (Tema)

Abidjan

Luanda

Walvis Bay

Cape Town

Zanzibar

Nosy Be

Toamasina

Tolagnaro

Richards Bay

Durban



Praslin
La Digue
Mahe
Antisiranana
Port Louis
Pointe des Galets

Hue/Da Nang (Chan May)
Bangkok (Klong Toey)
Yangon
Trincomalee
Galle
Hithadhoo
Phuket
George Town
Singapore
Ho Chi Minh City
Tagbilaran
Halong Bay
Hong Kong
Manila

Romblon Island
Kalanggaman Island

Koror
Rabaul
Madang
Alotau
Champagne Beach
Mystery Island

**PERSONALISED
FLIGHT JOURNEY**
by Qantas Airways

Sydney
Hobart
Milford Sound
Dunedin (Port Chalmers)
Auckland
Bay of Islands
Tauranga
Napier
Wellington
Akaroa



MILFORD SOUND, NEW ZEALAND

ALL THE WORLD'S A STAGE

From the South Seas to deep inside the Amazon, join this inspiring epic where you're both spectator and storyteller. Set off on an exotic voyage to some of the world's most unique and remote places, for a legendary tale that weaves together a kaleidoscope of sights, sounds and stories. You'll be treated to inspiring performances, events and celebrations along the way, hosted by the extraordinary people you'll meet at each destination. A new way to see the world, South Side Story is destined to become an instant classic.

THE WORLD IS AT YOUR DOOR

Start your World Cruise journey as soon as you leave home! Let us take care of all the details: a private airport transfer, VIP meet and greet, private assistance, business class lounge access, exclusive fast-track for check-in, boarding and arrival and a personalised flight journey. Experience a new level of comfort in Qantas Business Class with more space to relax and a dedicated cabin. World Cruise passengers will taste the freshest seasonal ingredients and enjoy Australian hospitality in-flight, presented by Qantas Airways in partnership with Silversea. Upon arrival we'll take you straight to *Silver Shadow*, where your butler awaits.

DOOR-TO-DOOR PERSONALISED JOURNEY

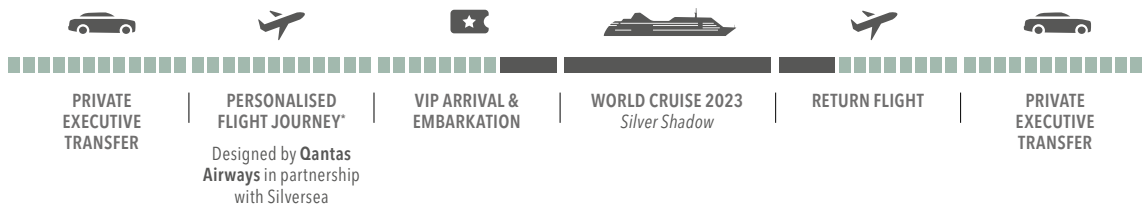

*From selected US and UK gateways



CHAPTER

FROM SIDNEY TO AUCKLAND

1 MYSTICAL LANDS AND WONDERS



For the first time in history we start our World Cruise with an overnight in Sydney. After enjoying Australia's culture capital after dark, set sail for Hobart; the cosmopolitan city in Australia's most southerly state. New Zealand is next, and a spectrum of experiences from the ethereal beauty of Milford Sound to the mighty scenery of Picton.



VIEW FROM TOP OF MT WELLINGTON, TASMANIA

HOBART (TASMANIA) / 12-13 January

Explore booming Hobart during an overnight. An ex-penal colony, nowadays Australia's second-oldest city is encircled by dramatic cliffs, landscaped gardens, undulating mountains and endless ocean views. Generous sunshine and cool Antarctic breezes help Hobart to produce its acclaimed wines, so be sure to taste a glass of local Pinot Noir.



WATERFALL IN MILFORD SOUND, NEW ZEALAND

MILFORD SOUND (NEW ZEALAND) / 16 January

Milford Sound sits within South Island's Fiordland National Park. As one of the four national parks forming the UNESCO World Heritage site "Te Wahipounamu" - pounamu being the local greenstone used for carvings by the Maori - expect steep cliffs, impressive waterfalls and dense rainforest that characterise this 8th wonder of the world.



AKAROA, NEW ZEALAND

AKAROA (NEW ZEALAND) / 18 January

There are many stunning places in New Zealand, but none of them can quite hold a candle to Akaroa. At less than 50 km from Christchurch, the town (Maori for "Long Harbour") stands on a peninsula formed by two volcanic cones. Self-styled as nature's playground, such a moniker might seem superlative elsewhere, but, surrounded by natural wonders, Akaroa's epithet is well earned.

EXCLUSIVE WORLD CRUISE EVENT

SAUVIGNON BLANC AT SUNSET



VINEYARD AT SUNSET, NEW ZEALAND

19 JANUARY 2023 - PICTON (NEW ZEALAND)

With great wine, excellent food and a blend of culture and entertainment, our first World Cruise event promises to be amazing! Enjoy a cellar tour before settling down to enjoy an evening of gastronomic pairings in the stunning setting of one of New Zealand's most renowned wineries.



CHAPTER

FROM AUCKLAND TO MANILA

2

MYTHS AND RITUALS



VIEW ON THE CORAL REEFS, PAPUA NEW GUINEA

Weave your way through Melanesia and some of the world's most remote islands. Pass by the gloriously undeveloped archipelago Bay of Islands before setting foot on Vanuatu's South Pacific paradise. Three full days in Papua New Guinea offer a life changing opportunity to understand the deep roots of Papua's age-old culture through the traditional dances of Rabaul and Madang.



MYSTERY ISLAND, ANELGHOWHAT (VANUATU) / 28 January

The uninhabited Mystery Island carries its name well. Located at the bottom of the 40-island Vanuatu archipelago, Mystery Island is less than 160 km² yet bears the weight of almost 3,000 years of ni-Vanuatu history. Visitors are always welcome here, so don't be surprised if locals from other islands sail over to share their tales and traditions.



RABAUL (PAPUA NEW GUINEA) / 03 February

Rabaul's remote location together with the fact it is built on one of the most active volcanoes in Papua New Guinea means tourism is not rife. This is Papua at its most authentic, linguistically diverse, astonishing cultural variety and a great expression of identity. Divers will also be richly rewarded - the marine life is extraordinary.



ROMBLON (PHILIPPINES) / 12 February

Mesmerising, paradisiacal sands and sparkling waters sum up Romblon. These islands create a truly stirring vision of Asian beauty - dazzling all visitors who head for these turquoise fringed shores. Remote and remarkable, enjoy the staggeringly picturesque archipelago that make the Philippines so very covetable.

EXCLUSIVE WORLD CRUISE EVENT – FULL SHIP

THE MAGIC OF MELANESIA



TRADITIONAL CEREMONY OF CHAMPAGNE BEACH, VANUATU

29 JANUARY 2023 - CHAMPAGNE BEACH (VANUATU)

Enjoy an exceptional celebration of Vanuatu's melting pot of ethnic groups by enjoying a traditional Sing-Song. Performers from all over the islands, including the famous female drummers from Torba, will come and perform their cultural individuality through the mediums of music and dance.



EXCLUSIVE WORLD CRUISE EVENT

THE FIRE DANCERS OF MELANESIA



BAINING FIRE CEREMONY, RABAU, PAPUA NEW GUINEA

3 FEBRUARY 2023 - RABAU (PAPUA NEW GUINEA)

Enjoy a performance of the secret Baining fire ceremony – a dance to invoke the spirits of the forest. Performed only on rare occasions, initiated young men wear giant masks and dance barefoot on fire, chanting hypnotically. You share the secret; you lose the magic!



EXCLUSIVE WORLD CRUISE EVENT - FULL SHIP

YOUR OWN PIECE OF PARADISE

AERIAL VIEW OF KALANGGAMAN ISLAND, PHILIPPINES

11 FEBRUARY 2023 - KALANGGAMAN ISLAND (PHILIPPINES)

If limpid waters, white sands and no one for miles are your idea of heaven, then welcome to Kalanggaman Island. This exceptional beach location is the stuff of desert island dreams - Silversea style! Enjoy all-inclusive, all-exclusive access to you own piece of paradise.



CHAPTER

FROM MANILA TO SINGAPORE

3

NEW WORLDS, OLD STORIES



BENCHAMABOPHIT TEMPLE IN BANGKOK, THAILAND

Six splendid overnights make this voyage something to write home about. Beginning with Manilla, you'll enjoy seeing another side of Hong Kong, Halong Bay, Ho Chi Minh City and Bangkok after the sun goes down. Explore the bottomless well of past, present and future that gives South East Asia its unique blend of culture and charisma after dark.



HA LONG BAY (VIETNAM) / 20-21 February

Ha Long Bay forms one of the most spectacular natural landscapes on the planet. At least 1,600 green islands rise over a flotilla of strung-together fishing boats and floating villages. Spectacular at any time, sunset bathes the remarkable limestone formations in warm, honey-coloured light, adding an extra layer to the seascape's heart-stirring beauty.



HUE, CHAN MAY (VIETNAM) / 22 February

There is a treasure trove of rich cultural experiences in Hue. It's hard resist the idyllic beaches, busy markets and iconic landmarks, but it is the city's Dragon Bridge that makes overnight guests swoon. The bridge comes alive at night, when light shows illuminate its flowing form, and the bridge's dragon head rasps fire into the dusk.



HO CHI MINH (VIETNAM) / 24-25 February

A chaotic, enchanting swirl of sensory stimulation, Ho Chi Minh City is a place of incense-infused temples, colonial architecture, warm people and delicious street food. Formerly known as Saigon, the city was affectionately-labelled Pearl of the Orient by the French. Spot the French connection that is everywhere – from the Notre Dame Basilica to the Saigon Post Office.

EXCLUSIVE WORLD CRUISE EVENT - FULL SHIP

THE CAVE OF DESCENDING DRAGONS



SUNG SOT (SURPRISE) CAVE, HALONG BAY, VIETNAM

20 FEBRUARY 2023 - HA LONG BAY (VIETNAM)

Enjoy an evening in one of the exotic caves of the Bay of the Descending Dragons. Enter the heart of fantasy from a skyline of rocks rising up from the emerald waters. Savour an authentic Vietnamese meal while talented dancers take you through Vietnam's regions.



CHAPTER

FROM SINGAPORE TO MAHE

4

A WEALTH OF CIVILISATIONS



SUPERTREE GROVE IN GARDENS BY THE BAY, SINGAPORE

Explore more during this fourth segment of our World Cruise. Travel through the Seychelles and Sri Lanka all the way to the Maldives, enjoying extended stays in port. Enjoy the dichotomy of Singapore's futuristic perfection, Phuket's dreamy, dramatic landscape and Yangon's heady mix of colonial past and glorious Burmese present.



YANGON (MYANMAR) / 8 - 10 March

Magnificent temples, monuments and pagodas glint in the sunshine of Yangon. Although it's no longer Myanmar's capital, Yangon remains the country's largest and most culturally alluring. The day starts early here; mingle with the locals by sipping *laphet yay* in one of the many inviting tea shops – Burmese black tea with condensed milk.



TRINCOMALEE (SRI LANKA) / 13-14 March

Built on a one of the world's largest natural harbours, Trincomalee is a gateway to the deep historical interests of Sri Lanka. Richly cultural and historic, the town is surrounded by treasured sites, many of which are UNESCO World Heritage. Explore the evocative and majestic holy sites in this multi-cultural, fascinating destination.



PRASLIN (SEYCHELLES) / 20 March

Loved by those who like their paradise au naturel, Praslin is one of the Seychelles' most beautiful islands. The difficulty in getting to it means there are no modern attractions. Entertainment here comes very much from the lush jungle, home to the famous and legendary Coco de Mer, as well as the surrounding sea.

CHAPTER

5

FROM MAHE TO CAPE TOWN

AFRICAN ENCOUNTERS



A healthy measure of relaxation and exploration comes next. Zanzibar's UNESCO Stone Town promises something extraordinary while authentic experiences take on a new meaning with the lemurs and baobabs of Madagascar. Follow this with some chic à la française in the Reunion and Mauritius, a dose of vitamin sea before the African mainland hoves into view.



ZANZIBAR (TANZANIA) / 25 - 26 March

There is much more to Zanzibar than meets the eye. Breathe in the heady scents and you'll understand why locals call it the Spice Isle. Zanzibar was once on the trading route from Arabia to Africa, the epicentre of which was in the Market Square in the heart of Stone Town. Today Stone Town is a popular UNESCO World Heritage Site.



TOAMASINA (MADAGASCAR) / 31 March

Situated on the east coast of Madagascar, Toamasina is defined by long beaches, endemic flora and fauna, as well as plantations of coffee, vanilla, clove, banana, coconut and lychee. The city itself is a jumble of bric-a-brac chic – streets lined with palm trees sit alongside old, crumbling colonial buildings and traditional creole houses.



POINTE DES GALETS (REUNION) / 03 April

Balancing ecological diversity, soul-stirring panoramas, lively coastal cities and a sprinkling of white- or black-sand beaches, the Reunion is an extraordinarily varied island. Considered as one of the most beautiful of the Indian Ocean, *La Réunion* – to give it its French name – is magical, significant and paradisiacal in equimeasure.

EXCLUSIVE WORLD CRUISE EVENT

AN AFRICAN AFFAIR IN STONE TOWN



THE OLD FORT (NGOMÉ KONGWE) OF ZANZIBAR, TANZANIA

25 MARCH 2023 - ZANZIBAR (TANZANIA)

Experience an exclusive evening in the Old Arab Fort, the oldest building in Zanzibar dating from 1699. Enjoy a local gourmet experience including a cocktail and dinner followed by a bespoke show, specially produced in a tribute to the son of Zanzibar, Freddy Mercury.



CHAPTER

FROM CAPE TOWN TO DAKAR

6

TREASURES AND TRADITIONS

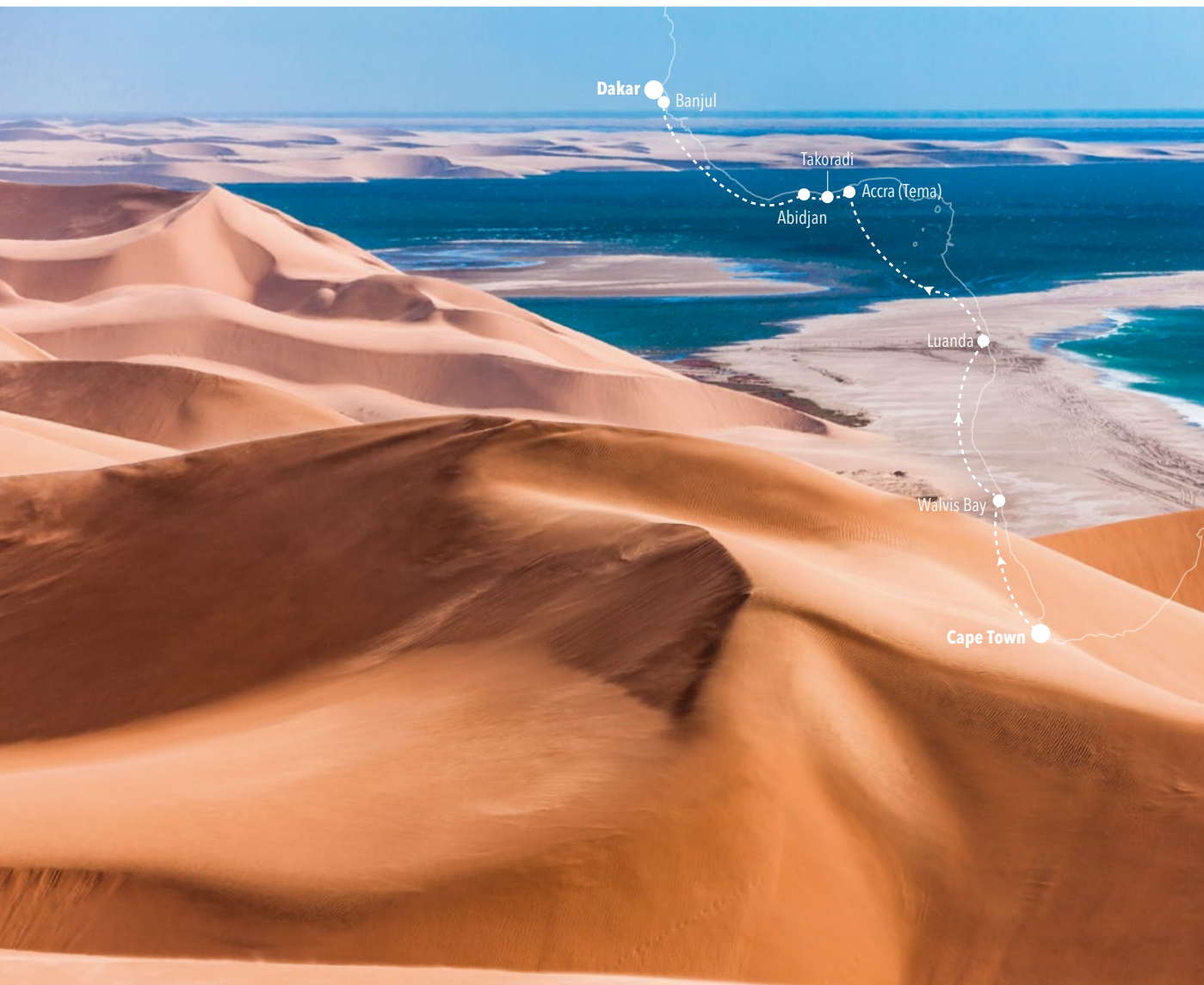

Dakar

Banjul

Takoradi

Abidjan

Accra (Tema)

Luanda

Walvis Bay

Cape Town

Earn your travel stripes by making the mythic journey up the Skeleton Coast. Leaving Cape Town and travelling to Dakar, experience one of the most thrilling stretches of coast there is. This is the Africa of your imagination, buzzing market life, towering desert dunes, lions stalking seals along dazzling white beaches and more shipwrecks than you can imagine.



CAPE TOWN (SOUTH AFRICA) / 12 - 14 April

Sprawling across endless blue coastline and watched over by the iconic Table Mountain, Cape Town is surely one of the world's most beautiful cities. A blend of spectacular scenery, multiculturalism and relaxed charm awaits in the Mother City, where you can venture out to rolling vineyards, dine in laid back suburbs, or explore cool urban culture.



WALVIS BAY (NAMIBIA) / 16-17 April

Home to a beautiful lagoon, washed pale pink by a colony of resident flamingos, Walvis Bay is a colourful African call and home to some of the continent's most flamboyant wildlife. The city is on the cusp of the sun-scorched Namib Desert beyond - the famous Dune 7 rises up 380 metres to form the highest sand dune in the country.



TAKORADI (GHANA) / 25 April

Like much of West Africa, Abidjan and Takoradi have soul in buckets. Both cities are bubbling with energy, enjoying a diversity of cultures from a strong French connection on the Ivory Coast to the colours and chaos of street in Ghana. These destinations are for travellers that come to Africa looking for iconic authenticity.

EXCLUSIVE WORLD CRUISE EVENT

THE GAME THAT MADE A NATION



TABLE MOUNTAIN AT SUNSET, CAPE TOWN, SOUTH AFRICA

13 APRIL 2023 - CAPE TOWN (SOUTH AFRICA)

Capture the spirit of ubuntu by sharing stories, music and food during a day of rugby themed festivities. Enjoy a game played by township children, before settling down to watch the Clint Eastwood movie *Invictus*; the rousing true story of how Nelson Mandela unified South Africa through athletic triumph.

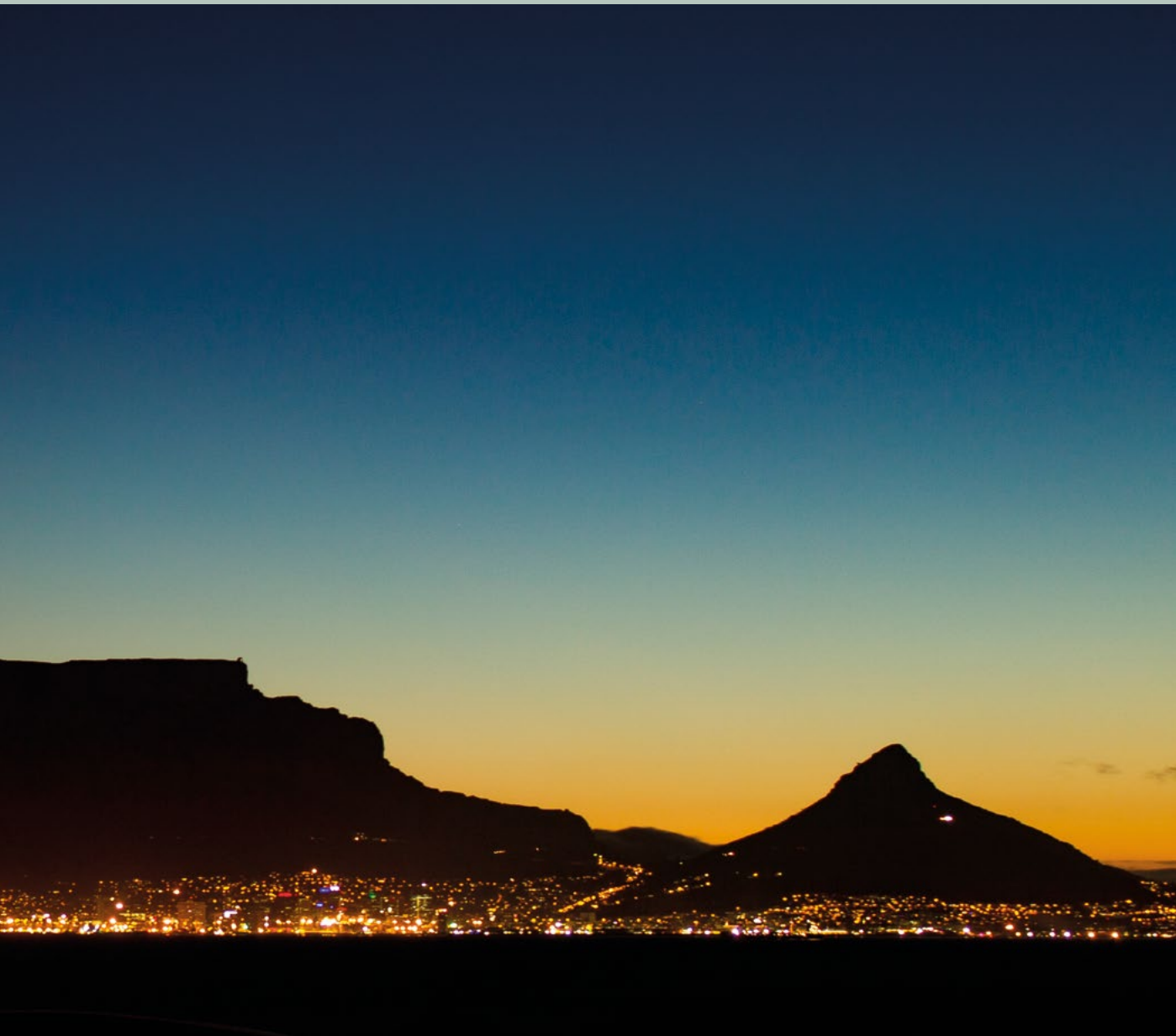

CHAPTER

FROM DAKAR TO MANAUS

7

WELCOME TO THE AMAZON

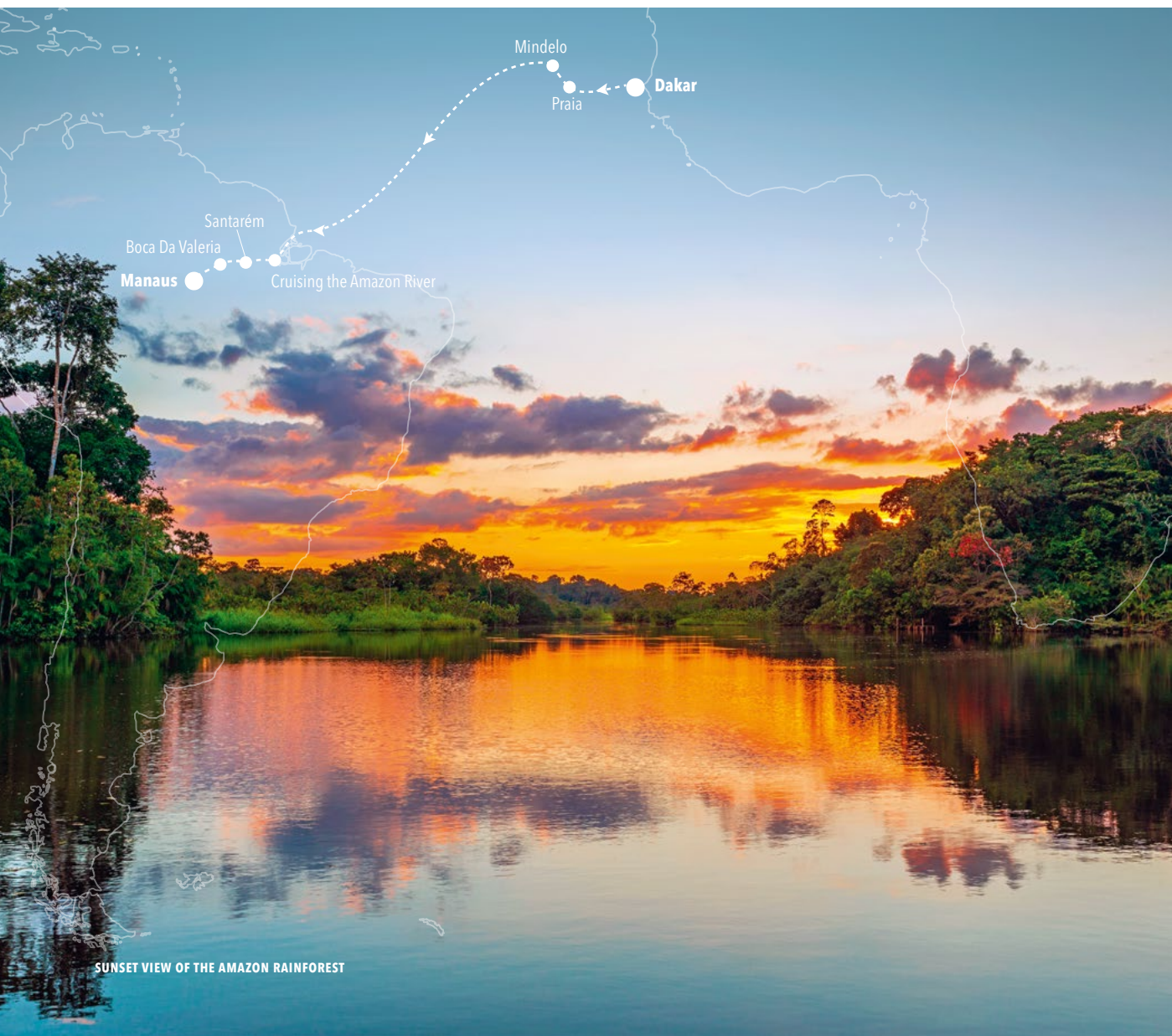

SUNSET VIEW OF THE AMAZON RAINFOREST

From Africa's east coast to the beating heart of Brazil. First stop off in Cape Verde before travelling across the Atlantic to step foot on terra firma in Macaba. But the highlight of this voyage is surely a trip along the mighty Amazon and the remarkable wildlife of the world's second longest river. All-new destinations make this segment an all-exciting adventure.

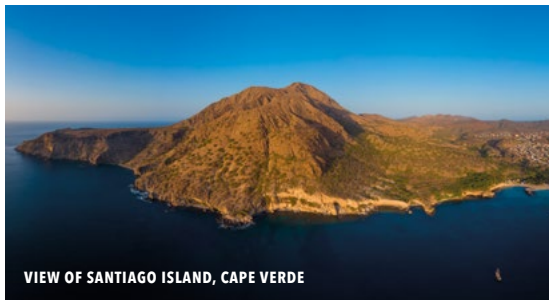

PRAIA (CAPE VERDE) / 3 - 4 May

At almost 300 miles off the coast of mainland west Africa, the remoteness of Cape Verde has allowed the archipelago's natural wildlife to flourish. The islands are a mini Galapagos, and that, along with astounding landscapes, a lively market, warm climate and clear waters are reason enough to fall in love with Praia's shabby grandeur.



SANTARÉM (BRAZIL) / 12 May

If you are looking for an authentic taste of rainforest culture, then look no further than Santarem. The little city is found at the confluence of the Amazon and Tapajós rivers and this "meeting of the rivers" phenomenon, where the crystal clear waters of the Rio Tapajós flow into the murky brown of the Amazon without merging is one of Santarem's biggest pulls.



MANAUS (BRAZIL) / 14 - 15 May

The famous Meeting of Waters, where tannin-rich water from the Rio Negro combines with milky water from the Rio Solimões to form the Amazon give Manaus its unique character. The jungle beckons visitors to explore and discover here - in the largest rainforest on Earth, it is easy to forget the hustle and bustle of the city and simply enjoy the wonders of nature.

EXCLUSIVE WORLD CRUISE EVENT – FULL SHIP

MUSIC, MAGIC AND MAGNIFICENCE



THE TEATRO AMAZONAS OPERA HOUSE, MANAUS, BRAZIL

14 MAY 2023 - MANAUS (BRAZIL)

Step back into Brazil's belle-époque history in the city's legendary theatre for a performance by the Amazonas Symphony and Choir. The Manaus Opera house is a truly remarkable example of Renaissance architecture, drawing illustrious guests from the world over.



CHAPTER

FROM MANAUS TO FORT LAUDERDALE

8

A KALEIDOSCOPE OF CULTURES



Fort Lauderdale

San Juan

Gustavia

St John's

Mayreau

Ile Royale

Cruising the Amazon River

Santarém

Manaus

Parintins

SEA TURTLE FLOATING UP AND OVER THE CORAL REEF

Leaving the Amazon in your wake, sail towards the final destination of the last leg of the 2023 World Cruise. Visit new destinations with old friends; exploring the history of Devil's Island, relaxing and enjoying the soft Caribbean beats of Mayreau and being spoilt by an exclusive au revoir in St John's. Arrive in a flurry of excitement in Fort Lauderdale.



PARINTINS (BRAZIL) / 16 May

Set on an island in the middle of the Amazon Rainforest, Parintins is rich with archaeological and indigenous remains. The small, friendly town is welcoming to visitors, and delights in sharing its regional cuisine – superbly fresh fish dishes and rich fruit based desserts. Stroll around the colourful market sampling as you go to get a literal taste of this lovely place.

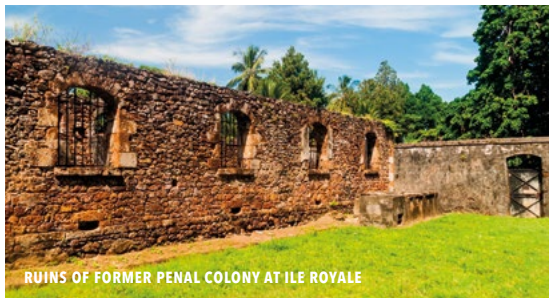

ILE ROYALE (FRENCH GUIANA) / 20 April

As you spot Dublin from the sea, you'd be forgiven for thinking you might've sailed back in time. Founded by the Vikings or Gaels, depending on who you ask, its castles, estates and Victorian gardens beckon you to explore an illustrious history, while parks like the Howth Head Cliff Walk bring you back to nature.



GUSTAVIA, ST BARTS (FRENCH WEST INDIES) / 24 May

Cherry red roofs, yacht-sprinkled bays and a sophisticated French flavour all add to the gorgeous Caribbean allure of Gustavia. St. Barts' capital rolls around a horseshoe-shaped harbour, where gleaming yachts hover and fancy boutiques, bars and restaurants fizz with and you'll no doubt spy more than one celebrity face on the famous beaches.

EXCLUSIVE WORLD CRUISE EVENT - FULL SHIP

YOUR PRIVATE CARIBBEAN



CARIBBEAN GRENADINES MAYREAU TROPICAL ISLAND BEACH

22 MAY 2023 - MAYREAU (ST VINCENT AND GRENADINES)

For sheer indulgence, nothing can match the luxury of a Caribbean private island experience. Think endless beaches, gin-clear waters, sparkling views and famous Silversea hospitality and you have the ultimate castaway fantasy. Bucket list? We think so.



EXCLUSIVE WORLD CRUISE EVENT

A WORLD-CLASS FAREWELL



FIREWORKS SHOW AT SUNSET

23 MAY 2023 - ST JOHN'S (ANTIGUA AND BARBUDA)

Enjoy an evening of authentic Caribbean hospitality. Be welcomed by the St. John's Governor General and his wife into his official residence for an evening of cocktails and canapés followed by a sit down dinner. Topped off by live entertainment and a bespoke firework display!





FLOATING MARKET IN DAMNOEN SADUAK, BANGKOK

A COMPLIMENTARY EXCURSION IN EVERY PORT

Enjoy a complimentary shore excursion in every single port of call throughout the entire 2023 World Cruise. Choose from a selection of over 180 excursions across the whole itinerary, including day trips suited to those visiting a destination for the first time and uniquely curated experiences for the well-travelled.

Our exclusive WORLD CRUISE COLLECTION

Discover our bespoke shore excursions

In our ongoing quest to get at the heart of the destination, we've designed a series of bespoke shore excursions that will awe and inspire, available exclusively to our World Cruise guests.

For real travellers, the destination is just the beginning. We know you love immersing yourselves into the destination for the deepest connection possible, so we've created a series of unforgettable experiences, available throughout our South Side Story itinerary. Designed by our Silversea destination architects, these distinctive experiences feature exclusive access to venues and activities that are often off-limits to regular travellers. Explore just a few of them here and get ready to put the amaze in amazing.



MT AMOS OVER LOOKING WINEGLASS BAY, TASMANIA

FREYCINET NATIONAL PARK
12-13 JANUARY 2023
Hobart (Tasmania)

Arrive by helicopter at beautiful Oyster Bay and meet your Indigenous guide. Explore the coastal tracks, rock platforms and wildlife together prior to tempting the taste buds with some local bush tucker followed by a gourmet lunch.



THE BAY OF LUANDA, ANGOLA

LUANDA AND MUSSULO ISLAND
20 APRIL 2023
Luanda (Angola)

Enjoy a private tour of Luanda's markets and monuments, prior to embarking on a 15-minute cruise to Mussulo Island for a delicious seafood lunch. Relax on the beach or by the pool before heading back to the ship.



LOCAL FISHERMAN SAILING FOR FISH, MOZAMBIQUE

PRAIA: FLAVOURS OF THE SEA
3-4 MAY 2023
Praia (Cape Verde)

During a specially curated World Cruise Collection, experience the highlights of Praia. Visit the market followed by a trip to a local farm for a chance to meet the farmer and enjoy a delicious farm to table lunch.

Our exclusive OVERLAND PROGRAMMES

Discover our selection of bespoke land programmes

Silversea's overland programmes are a treasure trove of once-in-a-lifetime experiences.

Curated especially for our World Cruise guests, these pioneering tours take you into the depth of your destination, and offer a chance to immerse yourself in some of the world's most incredible landscape. Enjoy travel opportunities the like of which you have undoubtedly never experienced before, from a champagne breakfast on Mount Everest to entering the secret world of the tribesmen of Papua New Guinea. Promising adventure and awe to all who are lucky enough to sail on our South Side Story World Cruise 2023, please believe us when we say these very special overland programmes are perhaps the most exciting we have ever offered.



ASARO MUDMEN, PAPUA NEW GUINEA

PNG HIGHLANDS
1 FEBRUARY 2023
Alotau (Papua New Guinea)

Be among the select few to witness the incredible cultures of the highlands of Papua New Guinea. See performances by the Huli people and the Asaro Mudmen, truly spectacular experiences that very few outsiders ever get to witness.



THE ANCIENT CITY OF PATAN, NEPAL

THE KINGDOM OF NEPAL
4 MARCH 2023
Singapore (Singapore)

Join our inaugural and exclusive overland to the Kingdom of Nepal. A plethora of experience awaits you here: from spotting the superb wildlife to flying by helicopter from Kathmandu to Mount Everest for a champagne breakfast.



SKELETON COAST, NAMIB DESERT, NAMIBIA

SKELETON COAST
13 APRIL 2023
Cape Town (South Africa)

The Skelton coast of Namibia is a fusion of sights and experiences. This air safari is a unique opportunity to view this amazing place from Sossusvlei, homing some of the highest sand dunes in the world, all the way to the Kunene River.

MONDAY, 9 JANUARY 2023, EMBARK SILVER SHADOW

DATE	PORTS	ARRIVE	DEPART
CHAPTER 1			
9 JAN	SYDNEY		☾
10 JAN	SYDNEY		18:00
11 JAN	DAY AT SEA		
12 JAN	HOBART	13:00	☾
13 JAN	HOBART		16:00
14 JAN	DAY AT SEA		
15 JAN	DAY AT SEA		
16 JAN	MILFORD SOUND	6:15	9:45
17 JAN	DUNEDIN (PORT CHALMERS)	9:00	19:00
18 JAN	AKAROA	8:00	17:00
19 JAN	PICTON	8:00	22:00
20 JAN	WELLINGTON	8:00	16:30
21 JAN	NAPIER	8:00	14:00
22 JAN	TAURANGA	9:00	18:00
CHAPTER 2			
23 Jan	AUCKLAND	7:00	☾
24 Jan	AUCKLAND		19:00
25 Jan	BAY OF ISLANDS	8:00	18:00
26 Jan	DAY AT SEA		
27 Jan	DAY AT SEA		
28 Jan	MISTERY ISLAND	7:00	14:00
29 Jan	CHAMPAGNE BEACH	12:00	21:00
30 Jan	DAY AT SEA		
31 Jan	DAY AT SEA		
1 Feb	ALOTAU	12:00	19:00
2 Feb	DAY AT SEA		
3 Feb	RABAUL	8:00	23:00
4 Feb	DAY AT SEA		
5 Feb	MADANG	7:00	15:00
6 Feb	DAY AT SEA		
7 Feb	DAY AT SEA		
8 Feb	KOROR	8:00	13:00
9 Feb	DAY AT SEA		
10 Feb	BOHOL (TAGBILARAN)	10:30	18:00
11 Feb	KALANGGAMAN ISLAND	8:00	18:00
12 Feb	ROMBLON ISLAND	8:00	17:00
CHAPTER 3			
13 Feb	MANILA	7:00	☾
14 Feb	MANILA		19:00
15 Feb	DAY AT SEA		

16 Feb	HONG KONG	12:00	☾
17 Feb	HONG KONG		☾
18 Feb	HONG KONG		19:00
19 Feb	DAY AT SEA		
20 Feb	HALONG BAY	8:00	☾
21 Feb	HALONG BAY		12:30
22 Feb	HUE/DA NANG (CHAN MAY)	7:00	19:00
23 Feb	DAY AT SEA		
24 Feb	HO CHI MINH CITY	8:00	☾
25 Feb	HO CHI MINH CITY		13:00
26 Feb	DAY AT SEA		
27 Feb	BANGKOK (KLONG TOEY)	9:00	☾
28 Feb	BANGKOK (KLONG TOEY)		18:00
1 Mar	DAY AT SEA		
2 Mar	DAY AT SEA		
CHAPTER 4			
3 Mar	SINGAPORE	7:00	☾
4 Mar	SINGAPORE		13:00
5 Mar	GEORGE TOWN	12:30	18:30
6 Mar	PHUKET	8:00	18:00
7 Mar	DAY AT SEA		
8 Mar	YANGON	15:30	☾
9 Mar	YANGON		☾
10 Mar	YANGON		16:00
11 Mar	DAY AT SEA		
12 Mar	DAY AT SEA		
13 Mar	TRINCOMALEE	8:00	☾
14 Mar	TRINCOMALEE		13:00
15 Mar	GALLE	8:00	18:00
16 Mar	DAY AT SEA		
17 Mar	HITHADHOO	8:00	16:00
18 Mar	DAY AT SEA		
19 Mar	DAY AT SEA		
20 Mar	LA DIGUE	8:00	
20 Mar	PRASLIN		23:00
CHAPTER 5			
21 Mar	MAHE	7:00	☾
22 Mar	MAHE		13:00
23 Mar	DAY AT SEA		
24 Mar	DAY AT SEA		
25 Mar	ZANZIBAR	8:00	☾

26 Mar	ZANZIBAR		13:00
27 Mar	DAY AT SEA		
28 Mar	NOSY BE	9:00	18:00
29 Mar	ANTSIRANANA	7:00	18:00
30 Mar	DAY AT SEA		
31 Mar	TOAMASINA	8:00	18:00
1 Apr	DAY AT SEA		
2 Apr	PORT LOUIS	8:00	18:00
3 Apr	POINTE DES GALETS	8:00	18:00
4 Apr	DAY AT SEA		
5 Apr	TOLAGNARO	8:00	18:00
6 Apr	DAY AT SEA		
7 Apr	DAY AT SEA		
8 Apr	RICHARDS BAY	8:00	23:00
9 Apr	DURBAN	8:00	18:00
10 Apr	DAY AT SEA		
11 Apr	DAY AT SEA		
12 Apr	CAPE TOWN	8:00	☾
CHAPTER 6			
13 Apr	CAPE TOWN		☾
14 Apr	CAPE TOWN		16:00
15 Apr	DAY AT SEA		
16 Apr	WALVIS BAY	13:00	☾
17 Apr	WALVIS BAY		18:00
18 Apr	DAY AT SEA		
19 Apr	DAY AT SEA		
20 Apr	LUANDA	8:00	18:00
21 Apr	DAY AT SEA		
22 Apr	DAY AT SEA		
23 Apr	DAY AT SEA		
24 Apr	ACCRA (TEMA)	8:00	18:00
25 Apr	TAKORADI	8:00	18:00
26 Apr	ABIDJAN	8:00	18:00
27 Apr	DAY AT SEA		
28 Apr	DAY AT SEA		
29 Apr	DAY AT SEA		
30 Apr	BANJUL	8:00	18:00
CHAPTER 7			
1 May	DAKAR	7:00	22:00
2 May	DAY AT SEA		
3 May	PRAIA	8:00	☾

4 May	PRAIA		18:00
5 May	MINDELO	8:00	18:00
6 May	DAY AT SEA		
7 May	DAY AT SEA		
8 May	DAY AT SEA		
9 May	DAY AT SEA		
10 May	DAY AT SEA		
11 May	CRUISING THE AMAZON RIVER		
12 May	SANTAREM	8:00	19:00
13 May	BOCA DA VALERIA	8:00	18:00
14 May	MANAUS	13:00	☾
CHAPTER 8			
15 May	MANAUS		18:00
16 May	PARINTINS	12:00	19:00
17 May	SANTAREM	8:00	16:00
18 May	CRUISING THE AMAZON RIVER		
19 May	DAY AT SEA		
20 May	ILE ROYALE	7:00	14:00
21 May	DAY AT SEA		
22 May	MAYREAU	8:00	17:00
23 May	ST JOHN'S	12:00	23:59
24 May	GUSTAVIA	8:00	17:00
25 May	SAN JUAN	7:00	13:00
26 May	DAY AT SEA		
27 May	DAY AT SEA		
28 May	FORT LAUDERDALE	7:00	

☾ Overnight in Port



**BENEFITS & INCLUSIONS
EXCLUSIVE TO WORLD CRUISE GUESTS**

BUSINESS CLASS AIR
(FROM SELECTED COUNTRIES/GATEWAYS)

PRIVATE EXECUTIVE TRANSFERS BETWEEN HOME, AIRPORT AND SHIP*

MEET & GREET**

ACCESS TO DESIGNATED AIRLINE LOUNGES**

PERSONALISED JOURNEY WITH EXCLUSIVE IN-FLIGHT ENHANCEMENTS
(ON SELECTED US&UK DEPARTURES)

FAST-TRACK VIP ARRIVAL AND EMBARKATION IN SYDNEY

BON VOYAGE RECEPTION, DINNER AND OVERNIGHT ONBOARD ACCOMMODATION

SHORE EXCURSIONS

\$1,000 ONBOARD SPENDING CREDIT PER GUEST (UP TO \$2,000 PER SUITE)

EXCLUSIVE WORLD CRUISE EVENTS

SPECIAL COMMEMORATIVE GIFTS

COMPLIMENTARY SILVER SHORE BAGGAGE VALET (UP TO 2 BAGS, 50LBS EACH, PER GUEST)

COMPLIMENTARY LAUNDRY SERVICE

COMPLIMENTARY UNLIMITED WI-FI

MEDICAL SERVICE***

VISA PACKAGE****

*Up to 60 miles per transfer | **At selected airports, on arrival/transfer to international flight to Sydney* | ***Between home and ship in Sydney and in Fort Lauderdale | ****Medical Service includes: visits to the Ship Medical Center, medical services typically provided for which we normally charge a fee, any medical tests administered onboard and medications prescribed by our onboard doctor to treat an ailment. We will not include refills on any prescription drugs, the cost of transferring a guest to land based facility for treatment, medical evacuations, or any other costs incurred off the ship.
****USA, Canada, UK, Germany, Australia only

SILVER SHADOW - DECK PLANS

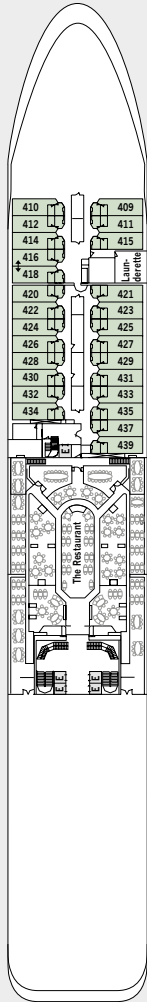

DECK 4

The Restaurant

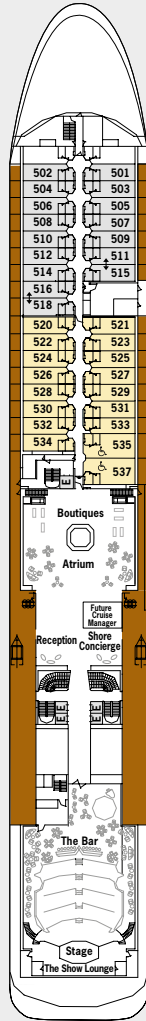

DECK 5

Boutiques
Atrium
Future Cruise Manager
Reception/Guest Relations
Shore Concierge
The Bar
The Show Lounge

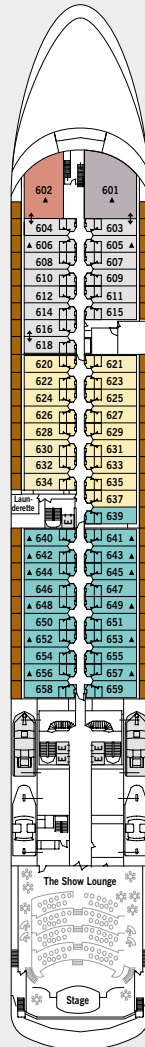

DECK 6

The Show Lounge

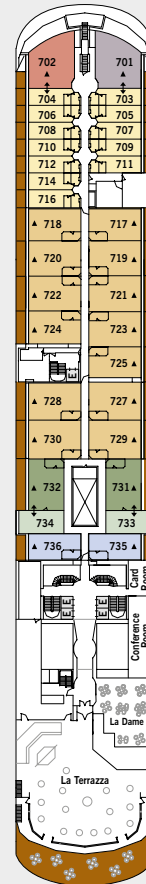

DECK 7

La Terrazza
La Dame
Conference/Card Room

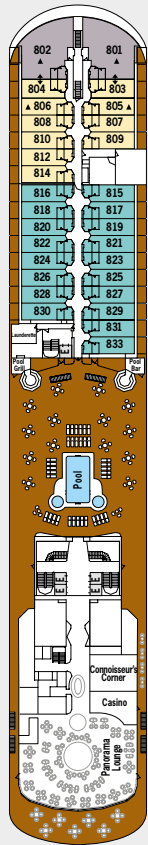

DECK 8

- Pool Deck
- Pool Bar
- The Grill
- Connoisseur's Corner
- Connoisseur's Corner Outdoor area
- Casino
- Panorama Lounge

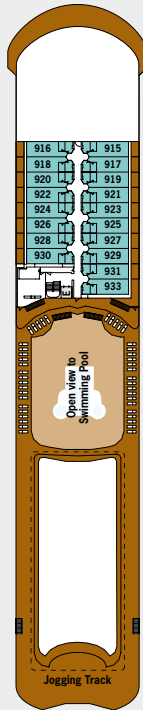

DECK 9

- Jogging Track

SUITE CATEGORIES

- Owner's Suite
- Grand Suite
- Royal Suite
- Silver Suite
- Medallion Suite
- Deluxe Veranda Suite
- Superior Veranda Suite
- Classic Veranda Suite
- Vista Suite



Deckplans are for illustration purposes only and may be subject to change.

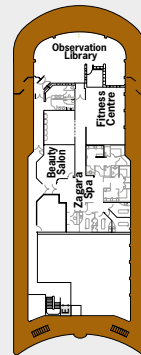

DECK 10

- Fitness Centre
- Zagara Beauty Spa
- Observation Library

SILVER SHADOW SUITES

Suite diagrams shown are for illustration purposes only and may vary from actual square footage. Please refer to suite specifications for square footage.

ALL SUITES FEATURE:

- BUTLER SERVICE
- REFRIGERATOR AND BAR SETUP STOCKED
WITH YOUR PREFERENCES
- PILLOW MENU
- LUXURY BATH AMENITIES
- PLUSH BATHROBE AND SLIPPERS
- PERSONALISED STATIONERY
- UMBRELLA
- COMPLIMENTARY WIFI
FOR ALL SUITES
- DIRECT-DIAL TELEPHONE(S)
- CHAMPAGNE ON ARRIVAL

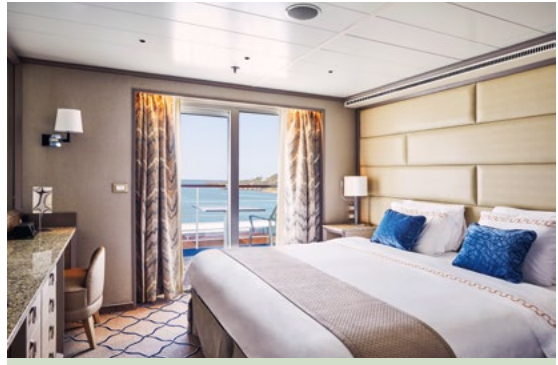

OWNER'S SUITE

Available as a one-bedroom configuration or as bedroom twos (as illustrated) by adjoining with a Vista Suite.

1 BEDROOM: 919 SQ. FT. / 85 M²
INCLUDING VERANDA (220 SQ. FT. / 20 M²);
2 BEDROOM: 1,264 SQ. FT. / 117 M²
INCLUDING VERANDA (220 SQ. FT. / 20 M²)

- Large veranda with patio furniture and floor-to-ceiling glass doors; bedroom two has additional large picture window
- Living room with sitting area; bedroom two has additional sitting area
- Separate dining area and bar
- Twin beds or queen-sized bed; bedroom two has additional twin beds or queen-sized bed
- Marble bathroom with double vanity, separate shower and full-sized whirlpool bath, plus a powder room; bedroom two has additional marble bathroom with full-sized bath
- Walk-in wardrobe(s) with personal safe
- Vanity table(s) with hair dryer
- Writing desk(s)
- 32" / 81 cm flat-screen television(s) with Interactive Media Library
- Bose® Sound system with bluetooth connectivity
- Unlimited Premium Wifi
- Illy® espresso machine





GRAND SUITE

Available as a one-bedroom configuration or as bedroom twos (as illustrated) by adjoining with a Veranda Suite.

1 BEDROOM: 941-1,090 SQ. FT. / 87-101 M²
INCLUDING VERANDA (103-116 SQ. FT. / 10-11 M²);
2 BEDROOM: 1,286-1,435 SQ. FT. / 119-133 M²
INCLUDING VERANDA (163-176 SQ. FT. / 16-17 M²)

- Large veranda with patio furniture and floor-to-ceiling glass doors; bedroom two has additional veranda
- Living room with sitting area; bedroom two has additional sitting area
- Separate dining area and bar
- Twin beds or queen-sized bed; bedroom two has additional twin beds or queen-sized bed
- Marble bathroom with double vanity, separate shower and full-sized whirlpool bath, plus a powder room; bedroom two has additional marble bathroom with full-sized bath
- Walk-in wardrobe(s) with personal safe
- Vanity table(s) with hair dryer
- Writing desk(s)
- 32" / 81 cm flat-screen television(s) with Interactive Media Library
- Bose® Sound system with bluetooth connectivity
- Unlimited Premium Wifi
- Illy® espresso machine



ROYAL SUITE

Available as a one-bedroom configuration or as bedroom twos (as illustrated) by adjoining with a Veranda Suite.

1 BEDROOM: 967-1,007 SQ. FT. / 90-94 M²
INCLUDING VERANDA (110-116 SQ. FT. / 10-11 M²);
2 BEDROOM: 1,312-1,352 SQ. FT. / 122-126 M²
INCLUDING VERANDA (170-176 SQ. FT. / 16-17 M²)

- Large veranda with patio furniture and floor-to-ceiling glass doors; bedroom two has additional veranda
- Living room with sitting area; bedroom two has additional sitting area
- Separate dining area and bar
- Twin beds or queen-sized bed; bedroom two has additional twin beds or queen-sized bed
- Marble bathroom with double vanity, separate shower and full-sized whirlpool bath, plus a powder room; bedroom two has additional marble bathroom with full-sized bath
- Walk-in wardrobe(s) with personal safe
- Vanity table(s) with hair dryer
- Writing desk(s)
- 32" / 81 cm flat-screen television(s) with Interactive Media Library
- Bose® Sound system with bluetooth connectivity
- Unlimited Premium Wifi
- Illy® espresso machine



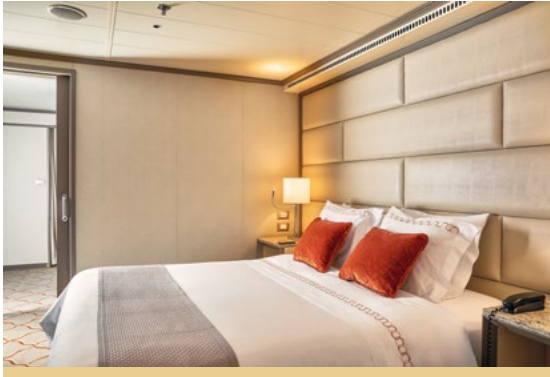

SILVER SUITE

Silver Suites accommodate three guests.

653-701 SQ. FT. / 61-65 M²
INCLUDING VERANDA (110-123 SQ. FT. / 10-11 M²)

- Veranda with patio furniture and floor-to-ceiling glass doors
- Living room (with convertible sofa to accommodate an additional guest)
- Sitting area
- Separate dining area
- Twin beds or queen-sized bed
- Marble bathroom with double vanity, separate shower and full-sized whirlpool bath
- Walk-in wardrobe with personal safe
- Vanity table with hair dryer
- Writing desk
- 32" / 81 cm flat-screen television(s) with Interactive Media Library
- Bose® Sound system with bluetooth connectivity
- Unlimited Premium Wifi
- Illy® espresso machine

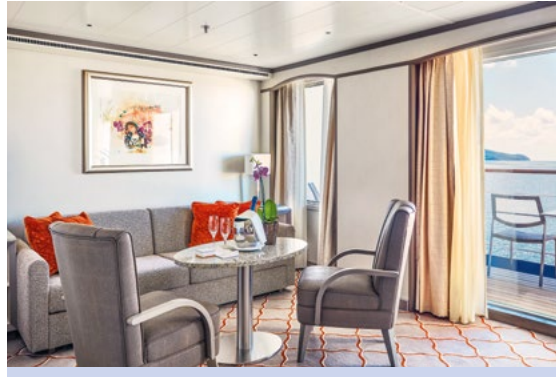

MEDALLION SUITE

Medallion Suites accommodate three guests.

521 SQ. FT. / 49 M²
INCLUDING VERANDA (81 SQ. FT. / 8 M²)

- Veranda with patio furniture and floor-to-ceiling glass doors
- Living room with sitting and dining area
- Twin beds or queen-sized bed
- Marble bathroom with double vanity, separate shower and full-sized whirlpool bath
- Walk-in wardrobe with personal safe
- Vanity table with hair dryer
- Writing desk
- 32" / 81 cm flat-screen television with Interactive Media Library
- Bose® Sound system with bluetooth connectivity
- Unlimited Premium Wifi
- Illy® espresso machine





DELUXE VERANDA SUITE / SUPERIOR VERANDA SUITE / CLASSIC VERANDA SUITE

Veranda Suites 605, 606, 640-645, 648, 649, 652, 653, 656 and 657 accommodate three guests. Deluxe Verandas offer preferred central location with identical accommodations to Classic and Superior Verandas.

345 SQ. FT. / 32 M²
INCLUDING VERANDA (60 SQ. FT. / 6 M²)

- Veranda with patio furniture and floor-to-ceiling glass doors
- Sitting area
- Twin beds or queen-sized bed
- Marble bathroom with double vanity, full-sized bath, separate shower
- Walk-in wardrobe with personal safe
- Vanity table with hair dryer
- Writing desk
- 32" / 81 cm flat-screen television with Interactive Media Library
- Unlimited Standard Wifi



VISTA SUITE

287 SQ. FT. / 27 M²

- Large picture window providing panoramic ocean views (Vista Suite)
- Sitting area
- Twin beds or queen-sized bed
- Marble bathroom with double vanity, full-sized bath, separate shower
- Walk-in wardrobe with personal safe
- Vanity table with hair dryer
- Writing desk
- 32" / 81 cm flat-screen television with Interactive Media Library
- Unlimited Standard Wifi



Images are intended as a general reference. Features, materials, finishes and layout may be different than shown.

NOTICE:

For U.S. cruises and guests: Prior to booking, please consult all applicable U.S. Centers for Disease Control travel advisories, warnings, or recommendations relating to cruise travel, available at <http://www.cdc.gov/travel/notices>. If a certain threshold level of COVID-19 is detected onboard your cruise ship during your voyage, your voyage will be ended immediately and the ship will return to the port of embarkation, and your subsequent travel, including your return home, may be restricted or delayed. For cruises and guests worldwide Health and safety protocols, guest conduct rules, and regional travel restrictions vary by ship and destination, and are subject to change without notice. Due to evolving health protocols, imagery and messaging may not accurately reflect onboard and destination experiences, offerings, features, or itineraries. These may not be available during your voyage, may vary by ship and destination, and may be subject to change without notice.

WORLD CRUISE T&C's:

Information contained herein does not form part of any offer or contract. Silversea's standard terms and conditions apply to the full World Cruise and all voyage segments unless specifically noted herein. Please refer to www.silversea.com for the most current schedules and fares. Single supplements apply, may vary by category and change over time. Silversea's "Included Shore Excursion Program" available also to full World Cruise guests.

DEPOSIT & PAYMENT (NON-DACH):

To reserve a suite on the full World Cruise or any World Cruise voyage segment, a 25% deposit of the total cruise fare is required. Deposits must be received within seven days of booking or sooner, depending on time of booking. Unless otherwise noted, final payment must be received by Silversea 180 days prior to cruise departure. For bookings made within 30 days of departure, final payment must be received within 48 hours. Silversea reserves the right to cancel any booking not fully paid at the time final payment is due. Payment may be made by cheque (US Funds), VISA, Master Card, American Express or Discover.

DEPOSIT & PAYMENT (DACH):

For DACH markets, different payment schedule applies: (a) Initial deposit: 25% of the cruise fare; (b) At 150 days, 50% of the total payment needs to be deposited; (c) At 120 days, 75% of the total payment needs to be deposited; (d) At 90 days, 90% of the total payment needs to be deposited; (e) Final payment to come not later than 30 days before departure.

CANCELLATIONS & REFUNDS:

If you find it necessary to cancel your reservation or any component thereof, you or your travel professional are required to contact the Silversea Reservations Department by telephone as well as submit your cancellation in writing. The following cancellation charges shall apply: From the date of deposit to 181 days prior to the initial sailing date: 500 USD / 450 EUR / 350 BPS / 650 CAD / 650 AUD per person; 180 - 151 days prior to the initial sailing date: 25% of the total cruise fare per person; 150 - 121 days prior to the initial sailing date: 50% of the total cruise fare per person; 120 - 91 days prior to the initial sailing date: 75% of the total cruise fare per person; 90 - 0 days prior to the initial sailing date or nonappearance at the time of sailing: 100% of the total cruise fare per person. Please note different conditions apply for German, Austrian and Swiss residents: From the date of deposit to 181 days prior to the initial sailing date: 10% of the total cruise fare per person; 180 - 151 days prior to the initial sailing date: 25% of the total cruise fare per person; 150 - 121 days prior to the initial sailing date: 50% of the total cruise fare per person; 120 - 91 days prior to the initial sailing date: 75% of the total cruise fare per person; 90 - 1 days prior to the initial sailing date: 90% of the total cruise fare per person; 1 - 0 days prior to the initial sailing date or nonappearance at the time of sailing: 95% of the total cruise fare per person.

Please note: Terms and Conditions can vary according to country. Please contact your travel or sales agent for complete information.

Guests who are booked on the full World Cruise (all segments) who cancel any portion of the cruise will have their entire booking cancelled and will be re-booked on the revised segment(s) subject to space availability at the time of change. Guests booked on the full World Cruise (all segments) in a Silver Suite or higher, who cancel any portion of the cruise will forfeit their suite. Silversea reserves the right to allocate suites or suite categories to specific combination segments; hence all suites or suite categories may not be available for specific segments or segment combinations. Changes are subject to cancellation penalties. All information herein is accurate and in effect at time of printing. Silversea reserves the right to correct any errors or omissions. Ship's registry: Bahamas.

FOR RESERVATIONS CONTACT YOUR TRAVEL ADVISOR OR SILVERSEA

ASIA	+65 6223 1846
AUSTRALIA	+1300 306 872
AUSTRIA	+43 8000 68 762
BELGIUM	+32 2 401 1432
DENMARK	+45 7014 2898
GERMANY	+49 69 2222 12283
FINLAND	+358 9 2319 5040
FRANCE	+33 1 7070 9622
IRELAND	+353 (01) 6110 560
ITALY	+39 02 3604 9211
JAPAN / KOREA	+81 (0) 3 6868 8834
LATAM	+1 888 978 2840
MONACO	+377 9770 2424
NETHERLANDS	+31 20 713 9298
NEW ZEALAND	+0800 701 427
NORWAY	+47 2103 3400
SWEDEN	+46 8 5068 5493
SWITZERLAND	+41 4458 07181
SPAIN	+34 9380 01962
UNITED STATES AND CANADA	+1 844 885 8417
UK	+44 (0) 207 340 0700

**FOR FURTHER DETAILS ON AVAILABILITY AND FARES VISIT
SILVERSEA.COM**